

## WALL SANITIZING STATIONS

### Spec Sheet

Ideal for tight areas (hallways, offices, staff areas, etc.). The "STOP: Clean Your Hands" sign is highly visible over the heads of crowds, encouraging hand hygiene at a distance.

**Tagg Clean-Hands<sup>®</sup> Sanitizing Stations are constructed from surgical-grade stainless steel for durability:**

- Corrosion-resistant
- Built for indoor and outdoor use
- Easy to clean

### Benefits of Wall Sanitizing Station Models:

- No damage to walls at the end of dispenser/liquid contracts - simply attach a new dispenser to the unit!
- Easy to assemble and install for barrier-free access with included instructions
- Ships flat with protective film
- Quick assembly and set up

### Includes the following:

- "STOP: Clean Your Hands" sign + bracket (where applicable)
- Clear message areas (where applicable)
- Mounting bracket system

### Available Models:



**SSW-16-A**  
2-shelf Wall  
(48"H x 20"W x 7.5"D)



**SSW-16-C**  
1-shelf Wall  
(32.75"H x 20"W x 7.5"D)



**SSWC-16**  
Compact Wall  
(17.5"H x 7"W x 4.75"D)

Install the bracket once and simply lift to remove the station! Includes security screw to keep the station tightly in place at any time.

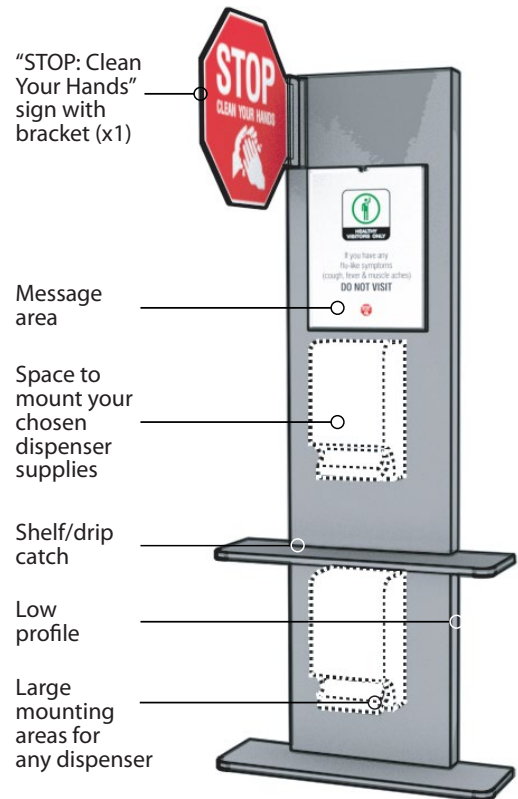

SSW-16-A



Shelf corner finish detail

***Together with our Wall Stations, Floor Stations, Symbols, Signage and Templates, you have a complete and reliable hand sanitizing solution!***

## FLOOR SANITIZING STATIONS

### Extended Column - Spec Sheet

Ideal for areas with high traffic (entranceways, lobbies, cafeterias, etc.). The "STOP: Clean Your Hands" sign is highly visible over the heads of crowds, encouraging hand hygiene at a distance.

**Tagg Clean-Hands® Sanitizing Stations are constructed from surgical-grade stainless steel for durability:**

- Corrosion-resistant
- Built for indoor and outdoor use
- Easy to clean

### Benefits of our Floor Sanitizing Station Models:

- Extended column or regular variations
- Optional stainless steel drawers, keyed alike
- Ships assembled with protective film
- Quick set-up

### Includes the following:

- "STOP: Clean Your Hands" sign + bracket
- Clear message areas (x4)
- Four commercial-grade, non-marking rubber foot-locking wheels

### Available Models:



**MSFC-ER-16**  
Extended Column  
No Drawers  
(22"L x 22"W x 69"H)



**MIU-ER-2-16**  
Extended Column  
2-drawer  
(22"L x 22"W x 69"H)

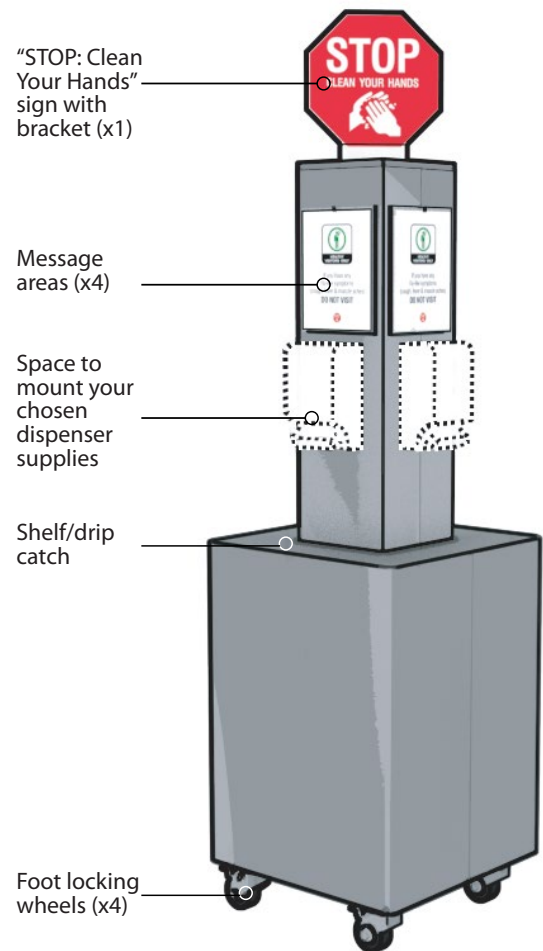

MSFC-ER-16

Table top  
corner  
finish detail



***Together with our Wall Stations, Floor Stations, Symbols, Signage and Templates, you have a complete and reliable hand sanitizing solution!***